

ZONING TYPE / A

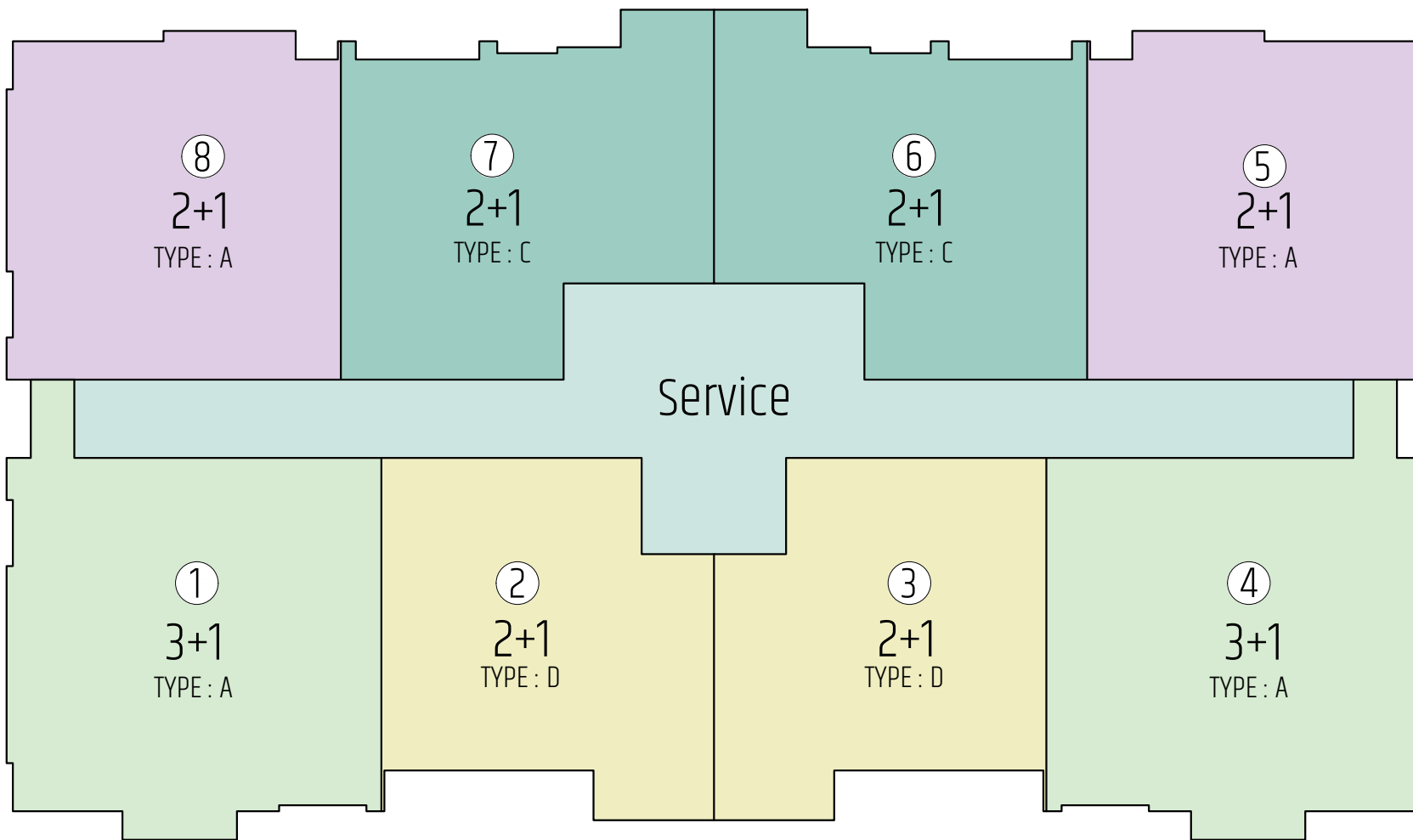

Typical Zoning For : (2nd , 4th , 5th , 7th , 8th , 10th , 11th , 13th , 14th , 16th , 17th , 19th , 20th , 22th , 23th , 25th , 26th , 28th , 29th) floor

TYPE A

Type : A 2+1
Net Area : 124.81 m²
Gross Area : 148.77 m²

Type : C 2+1
Net Area : 123.07 m²
Gross Area : 146.69 m²

Type : D 2+1
Net Area : 113.98 m²
Gross Area : 135.86 m²

Type : A 3+1
Net Area : 152.33 m²
Gross Area : 181.57 m²

Service
Service Area : 157.86 m²

2+1 = 6 3+1 = 2
Total unit per 1 floor = 8
Total NET Area : 1028.38 m²
Total GROSS Area : 1225.82 m²

ZONING TYPE / B

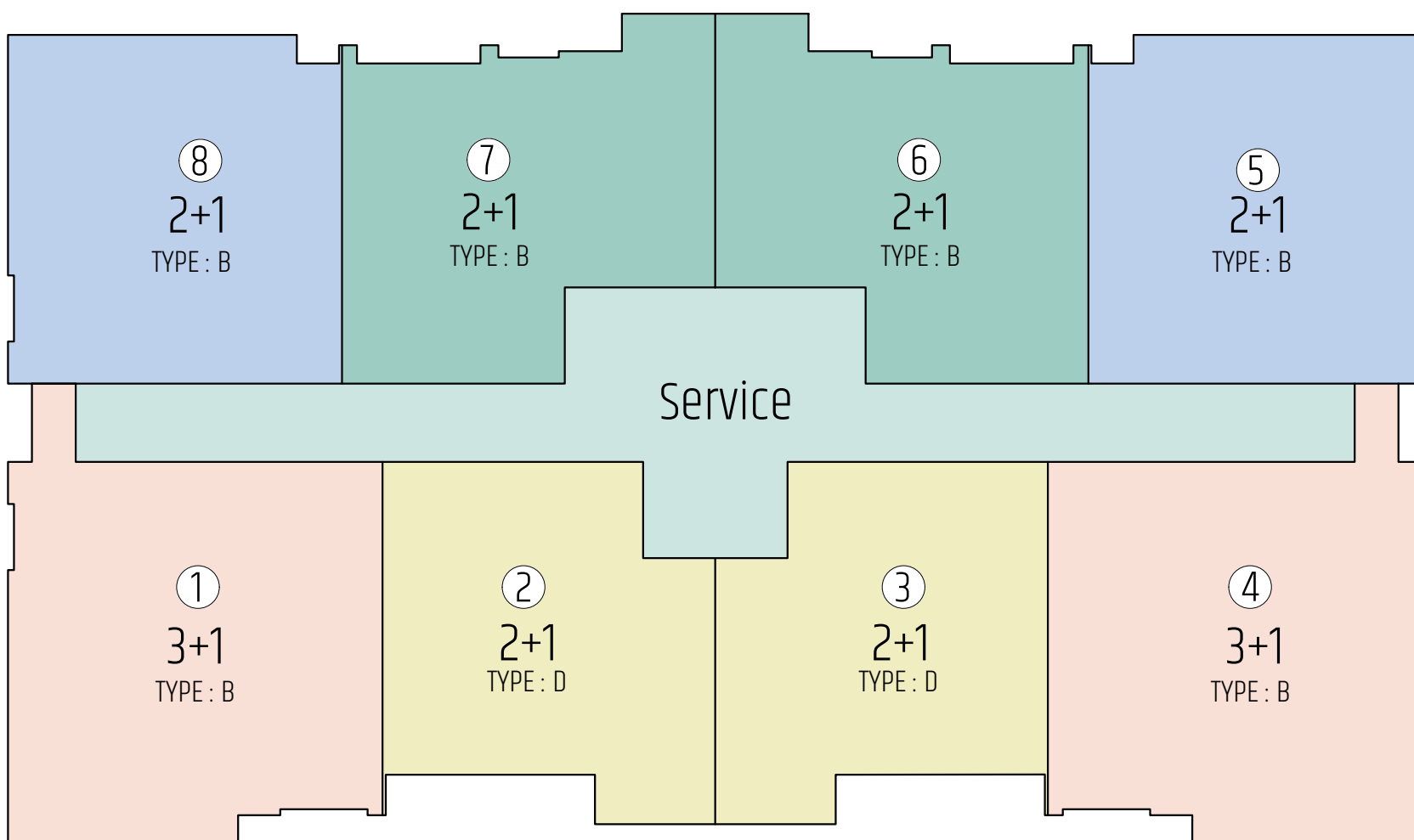

Typical zoning For : (3rd , 6th , 9th , 12th , 15th , 18th , 21th , 24th , 27th) floor

TYPE B

Type : B 2+1
Net Area : 126.95 m²
Gross Area : 151.32 m²

Type : C 2+1
Net Area : 123.07 m²
Gross Area : 146.69 m²

Type : D 2+1
Net Area : 113.98 m²
Gross Area : 135.86 m²

Type : B 3+1
Net Area : 156.32 m²
Gross Area : 186.33 m²

Service
Service Area : 157.86 m²

2+1 = 6 3+1 = 2
Total unit per 1 floor = 8
Total NET Area : 1040.61 m²
Total GROSS Area : 1240.40 m²